

City of New Ulm

Engineering Department

100 North Broadway

New Ulm, Minnesota 56073

Telephone: (507) 359-8245

Residential and Commercial Driveway Policy for Driveways in City Street Right-of-Ways

Residential Driveways

A minimum two inch (2") depth hot mixed bituminous surfacing or a minimum four inch (4") depth cast-in-place concrete each placed on a structurally sound, well drained granular subgrade suggested to be a minimum of six inches (6") in depth. The maximum width of a residential driveway within the public right-of-way is 24 feet.

Commercial Driveways

A minimum four inch (4") depth hot mixed bituminous surfacing or a minimum six inch (6") depth cast-in-place concrete each placed on a structurally sound, well drained granular subgrade suggested to be a minimum of eight inches (8") in depth. The maximum width of a residential driveway within the public right-of-way is 32 feet. City Engineer can allow for widths exceeding 32 feet under certain circumstances.

Bituminous Mixture

The suggested hot mixed bituminous pavement is to be Type SPA wearing course mixture PG 58-20, mix design SP WEA 240B.

Concrete Mixture

The Concrete shall be cast-in-place ready mix of 4000 P.S.I. mix design containing a well graded coarse aggregate of no more than one inch (1") in size. It is strongly recommended that the concrete be covered and allowed to cure for a period of at least 72 hours followed by an application of concrete treating oil when the surface is clean and dry. The concrete surface shall have a "broom" Finish. The sidewalk area shall be divided in panels of uniform size, generally five or six foot sections, with the remainder of the contraction joints in the driveway area spaced to provide adequate crack control.

Area Reserved for Sidewalk

The hard surface construction in the area reserved for sidewalk shall be cast-in-place concrete. However, if no sidewalk is presently located in this area, a bituminous surface may be constructed on a temporary basis. In the event a sidewalk improvement is ordered by the New Ulm City Council, the bituminous section shall be removed and replaced with cast-in-place concrete.

Maintenance

All surfaces shall be maintained to provide a structurally sound, smooth surface with no uneven displacement of one-half inch (1/2") or more.

CONCRETE APPROACH DETAIL

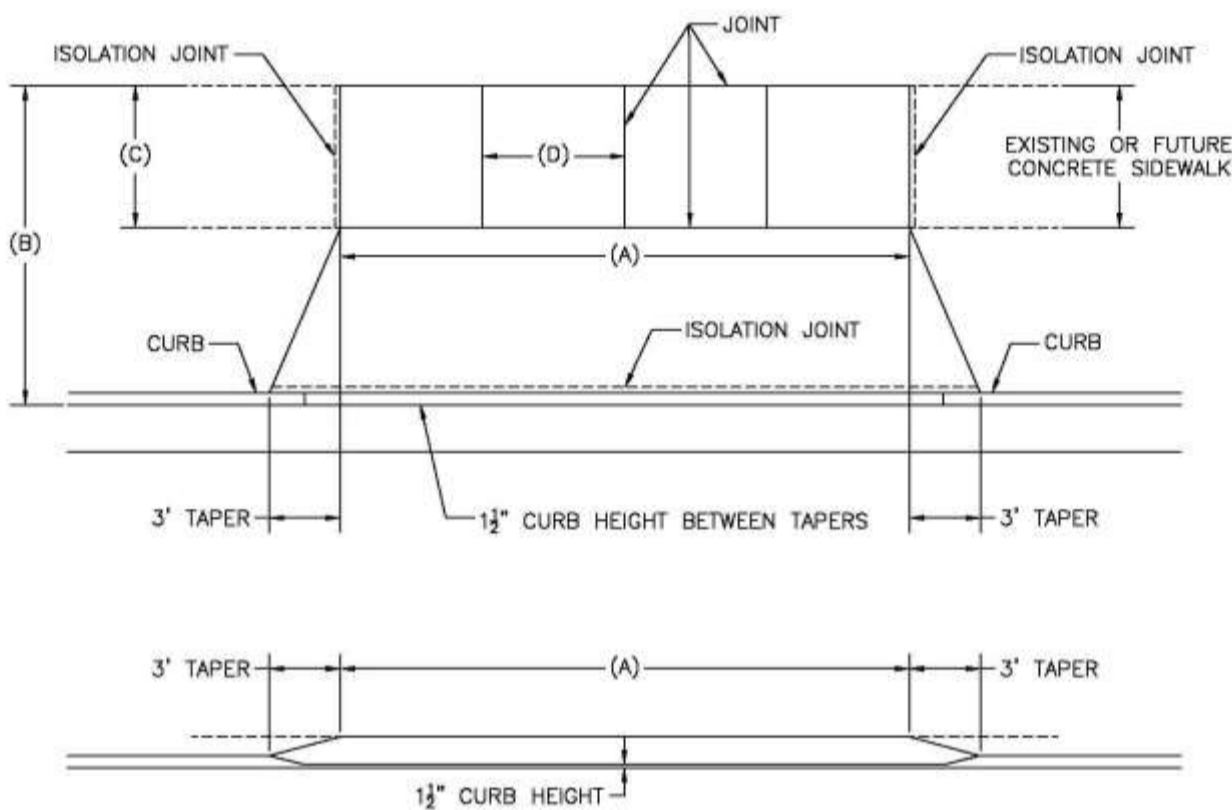

TYPICAL DRIVEWAY APPROACH CROSS SECTION

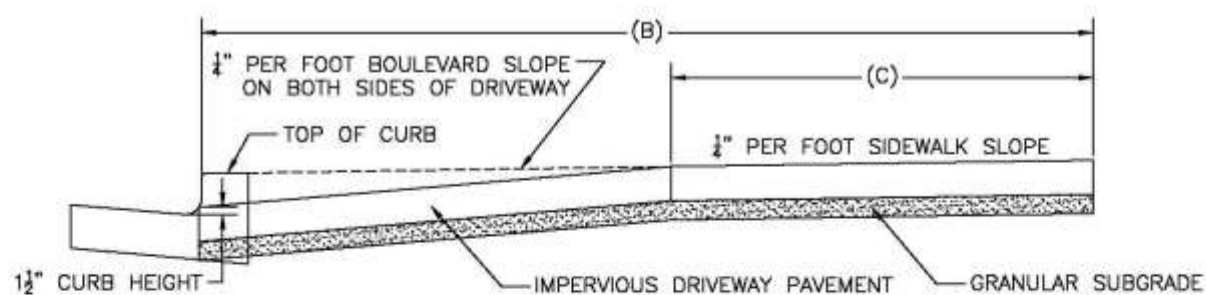

- | | |
|--|--|
| (A) 24' MAX. RESIDENTIAL | 32' MAX. COMMERCIAL |
| (B) 10' IN 60' R/W | 13' IN R/W THAT IS EQUAL OR GREATER THAN 80' |
| (C) 5' IN 60' R/W | 6' IN R/W THAT IS EQUAL OR GREATER THAN 80' |
| (D) SPACE BETWEEN CONTRACTION JOINTS EQUAL TO SIDEWALK WIDTH (C) | |

Z:/ENGINEERING/Driveway Permit and Information/Driveway Approach Detail Drawing